

# TECH BRIEF

## ADDITION TO THE 104-105-106 SERIES

### 105-H WITH MANUAL RELEASE

- Manual release feature is a valuable function for maintenance and servicing.



#### IDEALLY SUITED FOR:

- Motors
- Transformers
- Solenoids
- Printed circuit boards
- Hand-held machines and appliances
- Marine applications
- Recreation vehicles, campers
- And more...

Snap-Action and tease-free mechanism

Current Ratings	0.05 - 10 A
Voltage Rating	240 V AC; 48 V DC
Ambient Temp.	-20...+60°C (-4...+140°F)
0.05...8 A	2,000 operations at 1xIn
10 A	200 operations at 1xIn
Snap-in Panel Mounting	
Blade Terminals	

d		a		b
mm	inch	mm	inch	
0.8	.031	21.9	.862	11.3 <sup>+0.3</sup>
1.0	.039	22	.866	.445 <sup>+0.012</sup>
1.5	.059	22.1	.870	
2-3	.079-.118	22.2	.874	

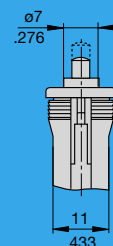
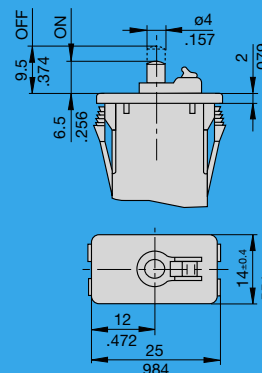
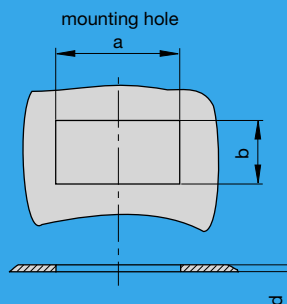

This is a metric design and millimeter dimensions take precedence (mm/inch)

For more information and application assistance please contact:  
**Markus Tegethoff, Technical Supervisor**  
847-827-7600 x132 or mtegetho@etacbe.com  
1551 Bishop Court Mt. Prospect, IL 60056